

Soils Map

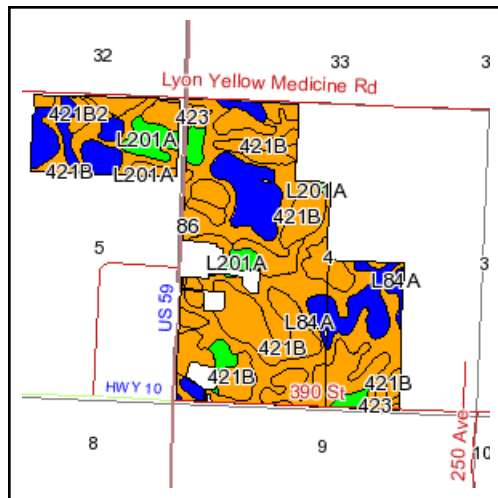

State: **Minnesota**
 County: **Lyon**
 Location: **004-113N-041W**
 Township: **Vallers**
 Acres: **433.6**
 Date: **11/4/2009**

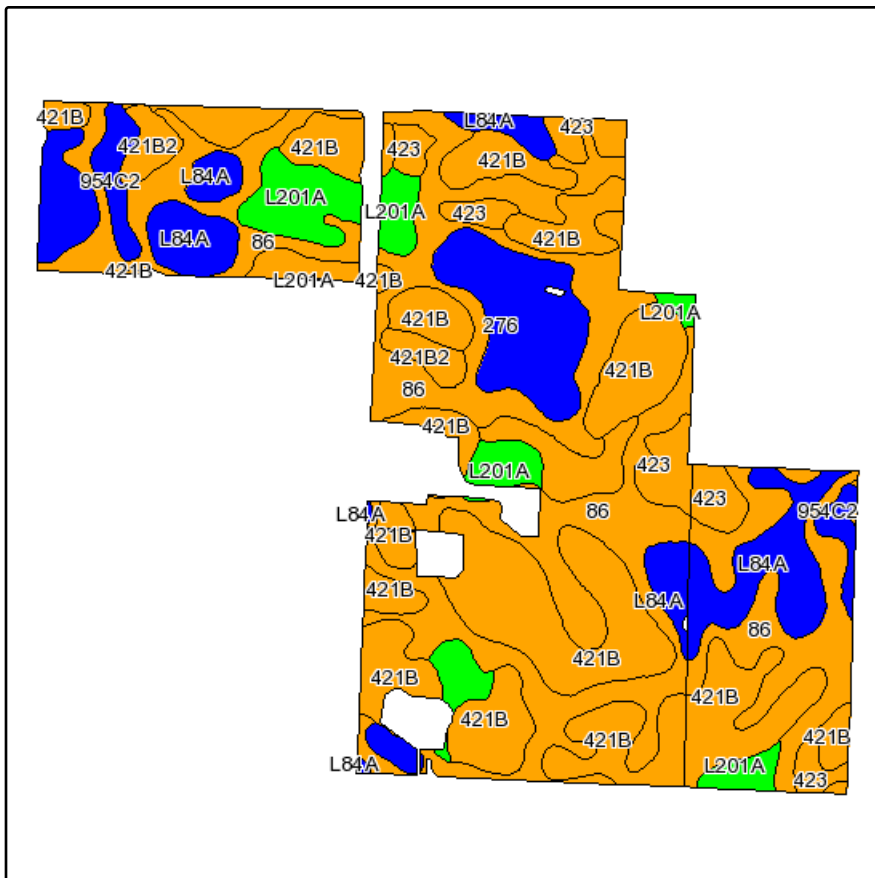
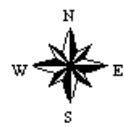

Maps provided by:



©AgriData, Inc 2008
www.AgriDataInc.com

Fsa borders provided by the Farm Service Agency as of May 23, 2008.
Soils data provided by USDA and NRCS.

Code	Soil Description	Acres	Percent of field	Non-Irr Class Legend	Non-Irr Class	Productivity Index	Corn	Soybeans
86	Canisteo clay loam	146	33.7%		IIw	93	164	51
421B	Ves loam, 1 to 4 percent slopes	137.3	31.7%		IIe	90	158	50
L84A	Glencoe clay loam, depressional, 0 to 1 percent slopes	48.2	11.1%		IIIw	86	155	47
423	Seaforth loam, 1 to 3 percent slopes	30.3	7.0%		IIs	95	167	52
L201A	Normania loam, 0 to 3 percent slopes	29.5	6.8%		I	99	150	47
276	Oldham silty clay loam	25.1	5.8%		IIIw	86	151	47
954C2	Storden-Ves loams, 5 to 12 percent slopes, eroded	9.2	2.1%		IIIe	77	136	42
421B2	Ves loam, 3 to 6 percent slops, eroded	8	1.8%		IIe	90	158	50
Weighted Average						91	158.9	49.6