

Soils Map

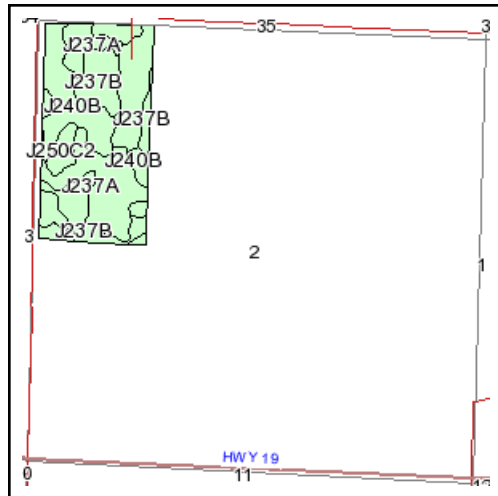

State: **Minnesota**
 County: **Lyon**
 Location: **002-111N-043W**
 Township: **Island Lake**
 Acres: **76.8**
 Date: **10/7/2009**

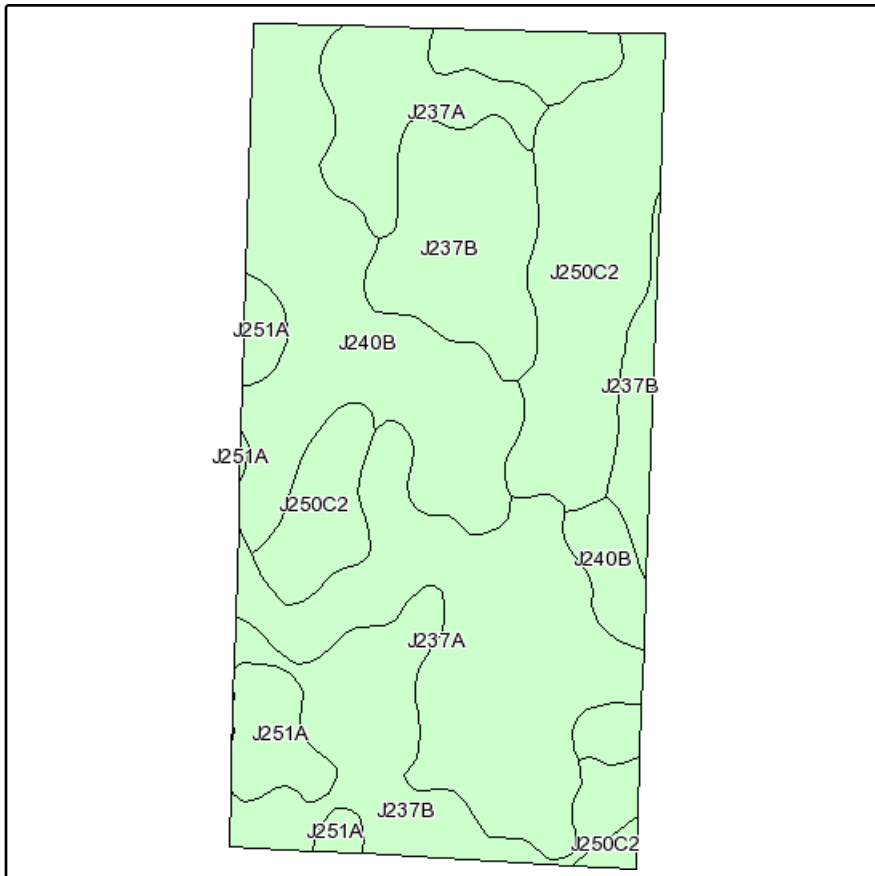
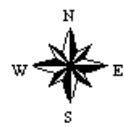

Maps provided by:



©AgriData, Inc 2008
www.AgriDataInc.com

Fsa borders provided by the Farm Service Agency as of May 23, 2008.
Soils data provided by USDA and NRCS.

Code	Soil Description	Acres	Percent of field	Non-Irr Class	Productivity Index	Corn	Soybeans	
J237A	Brensall-Tress complex, 0 to 2 percent slopes	21	27.4%	I	95	165	52	
J240B	Forman-Aastad complex, 3 to 6 percent slopes	19.7	25.6%	Ile	94	164	52	
J237B	Brensall-Tress complex 1 to 4 percent slopes	18.2	23.8%	Ile	95	165	52	
J250C2	Forman-Buse complex, 6 to 12 percent slopes, moderately eroded	14.3	18.6%	IIle	81	141	45	
J251A	Parnell silty clay loam, firm till, 0 to 2 percent slopes	3.6	4.7%	IIw	94	164	52	
Weighted Average						92.2	160.4	50.8