

# Soils Map

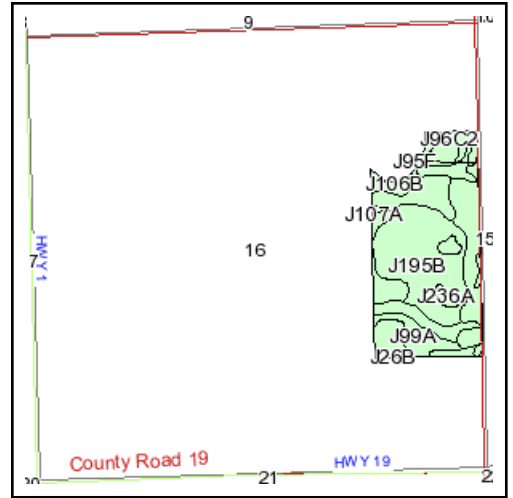

State: **Minnesota**  
 County: **Lincoln**  
 Location: **016-113N-046W**  
 Township: **Hansonville**  
 Acres: **70.7**

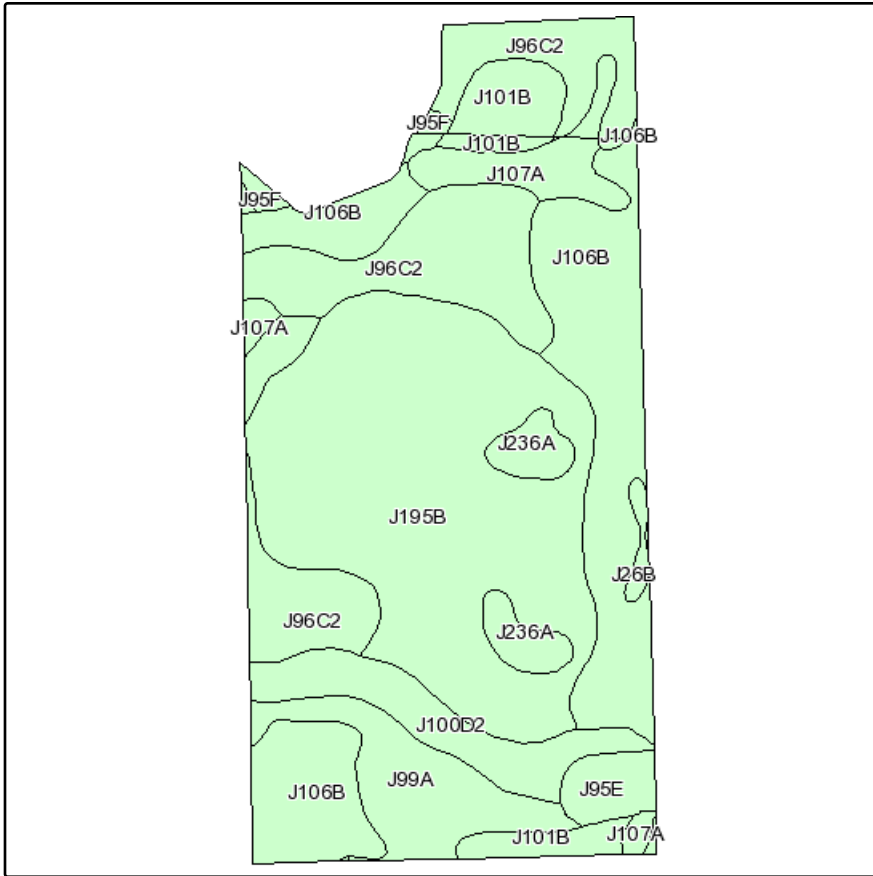
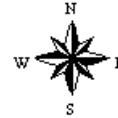

Maps provided by:



©AgriData, Inc 2008  
 www.AgriDataInc.com

Fsa borders provided by the Farm Service Agency as of May 23, 2008.  
 Soils data provided by USDA and NRCS.

Code	Soil Description	Acres	Percent of field	Non-Irr Class	Productivity Index	Corn	Soybeans	
J195B	Poinsett silty clay loam, 2 to 6 percent slopes	23.9	33.8%	Ile	91	158	50	
J106B	Barnes-Buse-Svea complex, 1 to 6 percent slopes	15	21.3%	Ile	88	153	48	
J96C2	Barnes-Buse complex, 6 to 12 percent slopes, moderately eroded	12	16.9%	IIle	80	139	44	
J99A	Lakepark clay loam, 0 to 3 percent slopes, overwash	4.6	6.6%	IIw	98	171	54	
J100D2	Buse, eroded-Wilno complex, 12 to 18 percent slopes	4	5.7%	IVe	64	111	35	
J101B	Hokans-Svea complex, 1 to 4 percent slopes	3.2	4.5%	Ile	98	171	54	
J107A	Lakepark-Roliss-Parnell, depressional, complex, 0 to 3 percent slopes	3	4.2%	IIw	93	162	51	
J236A	Highpoint Lake silty clay, 0 to 2 percent slopes	1.9	2.7%	IIs	90	157	50	
J95E	Buse, stony-Wilno complex, 18 to 25 percent slopes	1.4	1.9%	VIe	26			
J45F	Sandberg sandy loam, 12 to 40 percent slopes	0.8	1.1%	VIIe	20			
J95F	Buse, stony-Wilno complex, 25 to 40 percent slopes	0.5	0.7%	VIIe	17			
J26B	Darnen loam, 2 to 6 percent slopes	0.4	0.6%	Ile	99	172	54	
<b>Weighted Average</b>						<b>85.3</b>	<b>146.9</b>	<b>46.4</b>

# Soils Map

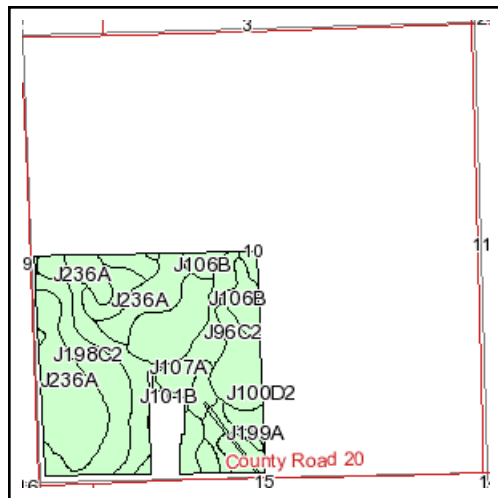
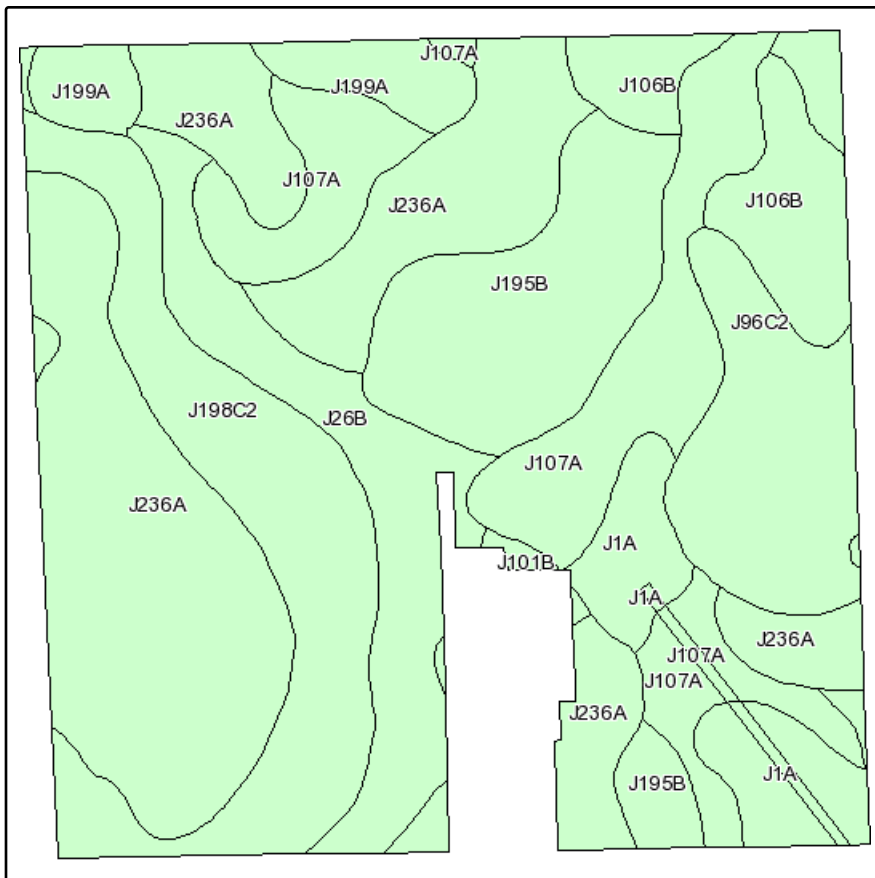

State: **Minnesota**  
 County: **Lincoln**  
 Location: **010-113N-046W**  
 Township: **Hansonville**  
 Acres: **147.3**

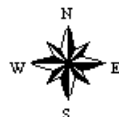

Maps provided by:



©AgriData, Inc 2008  
 www.AgriDataInc.com

Fsa borders provided by the Farm Service Agency as of May 23, 2008.  
 Soils data provided by USDA and NRCS.

Code	Soil Description	Acres	Percent of field	Non-Irr Class	Productivity Index	Corn	Soybeans
J236A	Highpoint Lake silty clay, 0 to 2 percent slopes	44.2	29.9%	IIs	90	157	50
J107A	Lakepark-Roliss-Parnell, depressional, complex, 0 to 3 percent slopes	20.9	14.2%	IIw	93	162	51
J198C2	Rusklyn-Poinsett complex, 6 to 12 percent slopes, moderately eroded	19.3	13.1%	IIIe	78	136	43
J195B	Poinsett silty clay loam, 2 to 6 percent slopes	15.7	10.6%	Ile	91	158	50
J96C2	Barnes-Buse complex, 6 to 12 percent slopes, moderately eroded	12.9	8.8%	IIIe	80	139	44
J26B	Darnen loam, 2 to 6 percent slopes	12.8	8.7%	Ile	99	172	54
J106B	Barnes-Buse-Svea complex, 1 to 6 percent slopes	8	5.4%	Ile	88	153	48
J1A	Parnell silty clay loam, depressional, 0 to 1 percent slopes	7.7	5.2%	IIIw	86	150	47
J199A	Fulda silty clay, 0 to 2 percent slopes	5.2	3.6%	IIw	86	150	47
J101B	Hokans-Svea complex, 1 to 4 percent slopes	0.5	0.4%	Ile	98	171	54
J100D2	Buse, eroded-Wilno complex, 12 to 18 percent slopes	0.1	0.0%	IVe	64	111	35
<b>Weighted Average</b>					<b>88.3</b>	<b>153.9</b>	<b>48.6</b>